

# MS4 Infrastructure Map

## in the Borough of Penns Grove

Salem County, N.J.

DATE: January 30, 2024

SCALE 1" = 200'

**General Notes and Data Sources:**  
 The Geographic Information System (GIS) data for this map was prepared by the New Jersey Geographic Information Network (NJGIN). The secondary product has not been verified by NJGIN and is not state authorized.  
 The areas, boundaries and details shown on map, are referenced, in part, from ground survey, aerial photography and recorded plans, tax assessment maps and as built documents, and are to be used for informational purposes only.  
 This map was created, in part, utilizing municipal boundary and location data provided by Penns Grove Borough.  
 Additional GIS resource data and imagery data was provided by the New Jersey Geographic Information Network (NJGIN). The secondary product has not been verified by NJGIN and is not state authorized.  
 All features are based on the following:  
 - NAD 83 Horizontal datum  
 - Penns Grove State Plane Coordinate System  
 - English units (US survey feet)  
 The geographic accuracy and precision of the GIS data contained in this map may not be as accurate as that of the original data source. The user is advised to verify the accuracy and precision of the GIS data before using it for any purpose.  
 Features designated with an asterisk (\*) have been field verified but not GPS located in the field. These features were located historically with hand-drawn digitizing based on historical imagery circa September 23, 2022.  
 Features designated with a double asterisk (\*\*) have been field verified but not GPS located in the field. These features were located historically with hand-drawn digitizing based on historical imagery circa April 13, 2018.

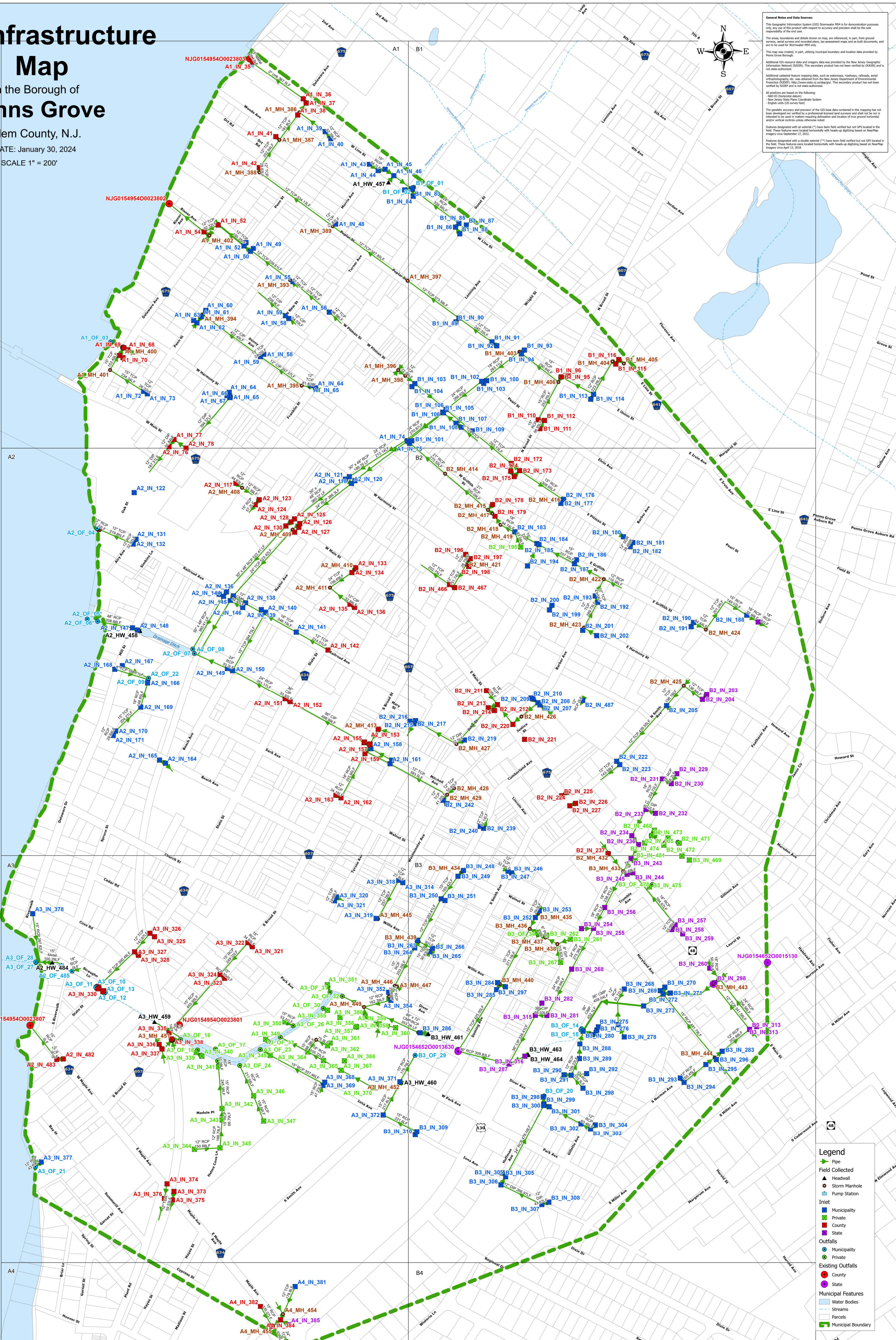
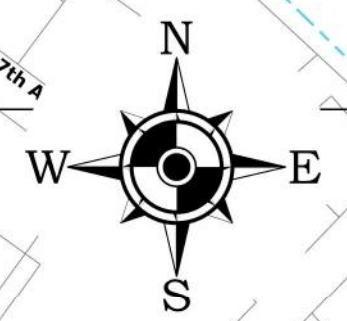

NO.	REVISION	DATE	BY	CHK

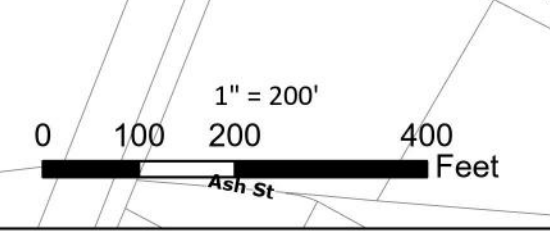

**REMINGTON & VERNICK ENGINEERS**  
 2059 SPRINGDALE ROAD, CHERRY HILL, NJ 08003  
 (856) 795-9595, FAX (856) 795-1882, RVE.COM  
 Certificate of Authorization: 24 CA 28003300  
 Excellence • Innovation • Service

- Legend**
- Pipe
  - Field Collected
  - Headwall
  - Storm Manhole
  - Pump Station
  - Inlet
  - Municipality
  - Private
  - County
  - State
  - Outfalls
  - Municipality
  - Private
  - Existing Outfalls
  - County
  - State
  - Municipal Features
  - Water Bodies
  - Streams
  - Parcels
  - Municipal Boundary